

Lisa Mackenzie

Senior Lecturer in Landscape Architecture

l.mackenzie@ed.ac.uk

Programme Director

The European Master's in Landscape Architecture - EMiLA

Edinburgh College of Art, The University of Edinburgh

13 November 2024



THE UNIVERSITY
of EDINBURGH



EMiLA

European Masters in
Landscape Architecture



THE UNIVERSITY
of EDINBURGH

EDINBURGH
xtraordinary futures await

Welcome live from Edinburgh!

- Audio Check
- Recording of the session
- Presentation
- Question and Answer
- Next steps





Audio check (Microsoft Teams)

- Can you hear the presenter speaking?
- Please type “no” in the Chat area **if you cannot hear the presenter**

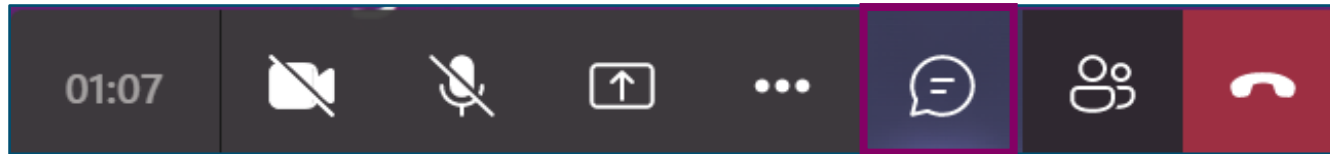

- If you can't hear:
 - Check your settings by clicking on the three little dots on the options bar and then 'show device settings'. Here you can check and change your speakers.
 - Try signing out and signing back into the session
 - Don't worry, the session is being recorded

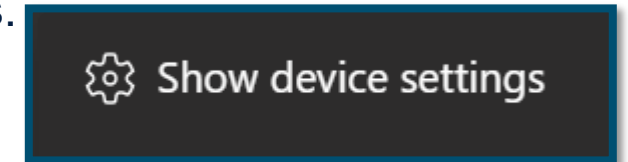



Live captions (Microsoft Teams)

You can turn on automated live captions as follows:

- More > Language and speech > Turn on live captions

These are automated therefore won't be 100% accurate

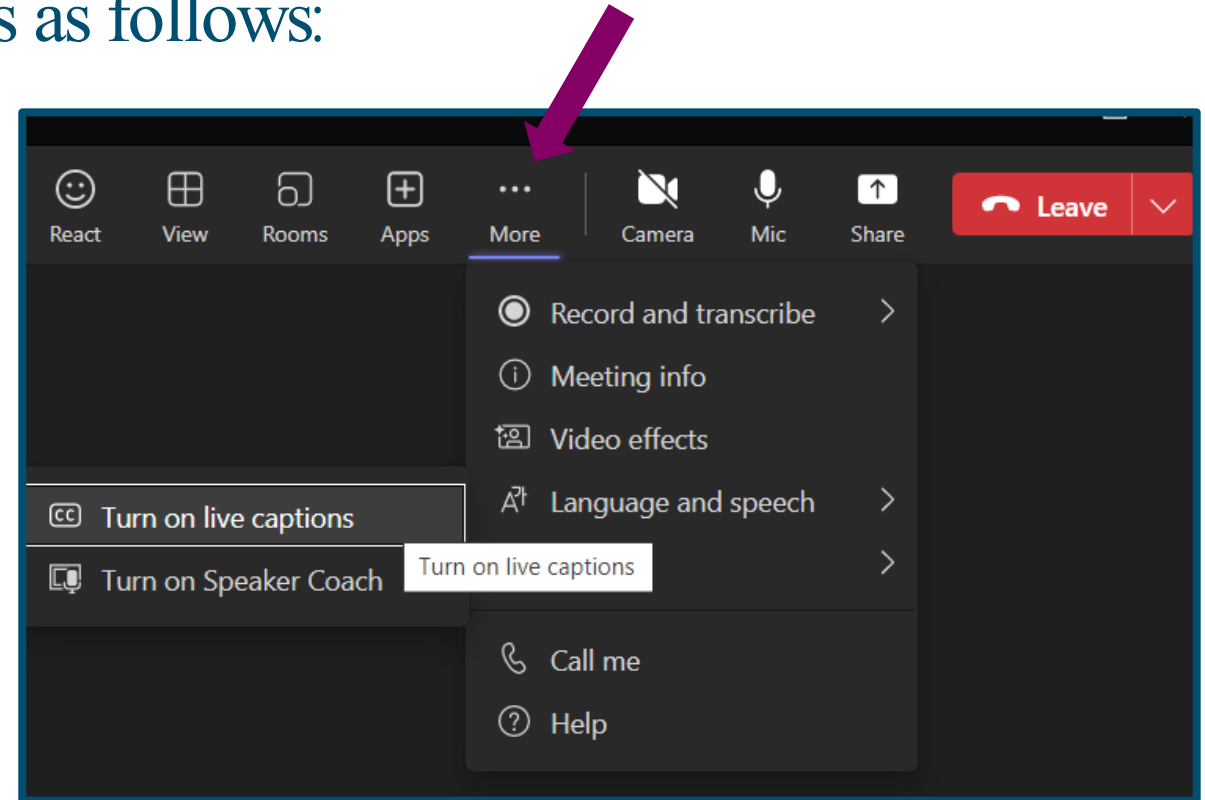

Recording



(MS Teams)

- Today's session is being recorded
- Any information that you provide during a session is optional and in doing so you give consent to process this information
- If you don't want your question or name read out in public, you can email your question to futurestudents@ed.ac.uk
- Please note a few attendees' names may be visible in the recording, if it is important that your name not be visible in the recording, please exit the session and use an incognito browser and typing in a pseudonym for yourself
- The session will be stored by the University of Edinburgh and published on our website the event on a non-indexed web page
- *You will be emailed with a link to watch the session recording by the end of next week*



Lisa Mackenzie

Senior Lecturer in Landscape Architecture

l.mackenzie@ed.ac.uk

Programme Director, The European Master's in
Landscape Architecture - EMiLA

Edinburgh College of Art, The University of
Edinburgh

13 November 2024



THE UNIVERSITY
of EDINBURGH



EMiLA

European Masters in
Landscape Architecture



THE UNIVERSITY
of EDINBURGH

EDINBURGH
xtraordinary futures await

EMiLA
Who:



EMiLA

European Masters in
Landscape Architecture



Escola Tècnica Superior d'Arquitectura de Barcelona



école
nationale
supérieure de
paysage
Versailles Marseille



THE UNIVERSITY
of EDINBURGH

EMiLA

How and why

the programme

Began:



LUH
HANNOVER

B1 1st - 2nd semester	B2 3rd- 4th semester	B3 5th- 6th semester	M1 7th- 8th semester	M2 9th- 10th semester
-----------------------------	----------------------------	----------------------------	----------------------------	-----------------------------

PhD	PhD	PhD
-----	-----	-----

ENSP
Versailles-
Marseille

L3 1st Year	M1 2nd Year	M2 3rd Year	Post M 4th Year
----------------	----------------	----------------	--------------------

PhD	PhD	PhD
-----	-----	-----

ECA
EDINBURGH

1st year	2nd year	3rd year	4th year	Master 5th
-------------	-------------	-------------	-------------	---------------

AHK
AMSTERDAM

M1 1st Year	M2 3rd Year
M1 2nd Year	M2 4thYear

PhD	PhD	PhD
-----	-----	-----

ETSA
BARCELONA

M1 1st Year	M2 2nd Year
M1 1st Year	M2 2nd Year

PhD	PhD	PhD
-----	-----	-----

Languages

French B1 CEFR Scale

German B1 CEFR Scale

Spanish (English B2) 6.5 IELTS – (Semester in English)

Amsterdam (English B2)



THE UNIVERSITY
of EDINBURGH



EMiLA

European Masters in
Landscape Architecture



THE UNIVERSITY
of EDINBURGH

EDINBURGH
xtraordinary futures await

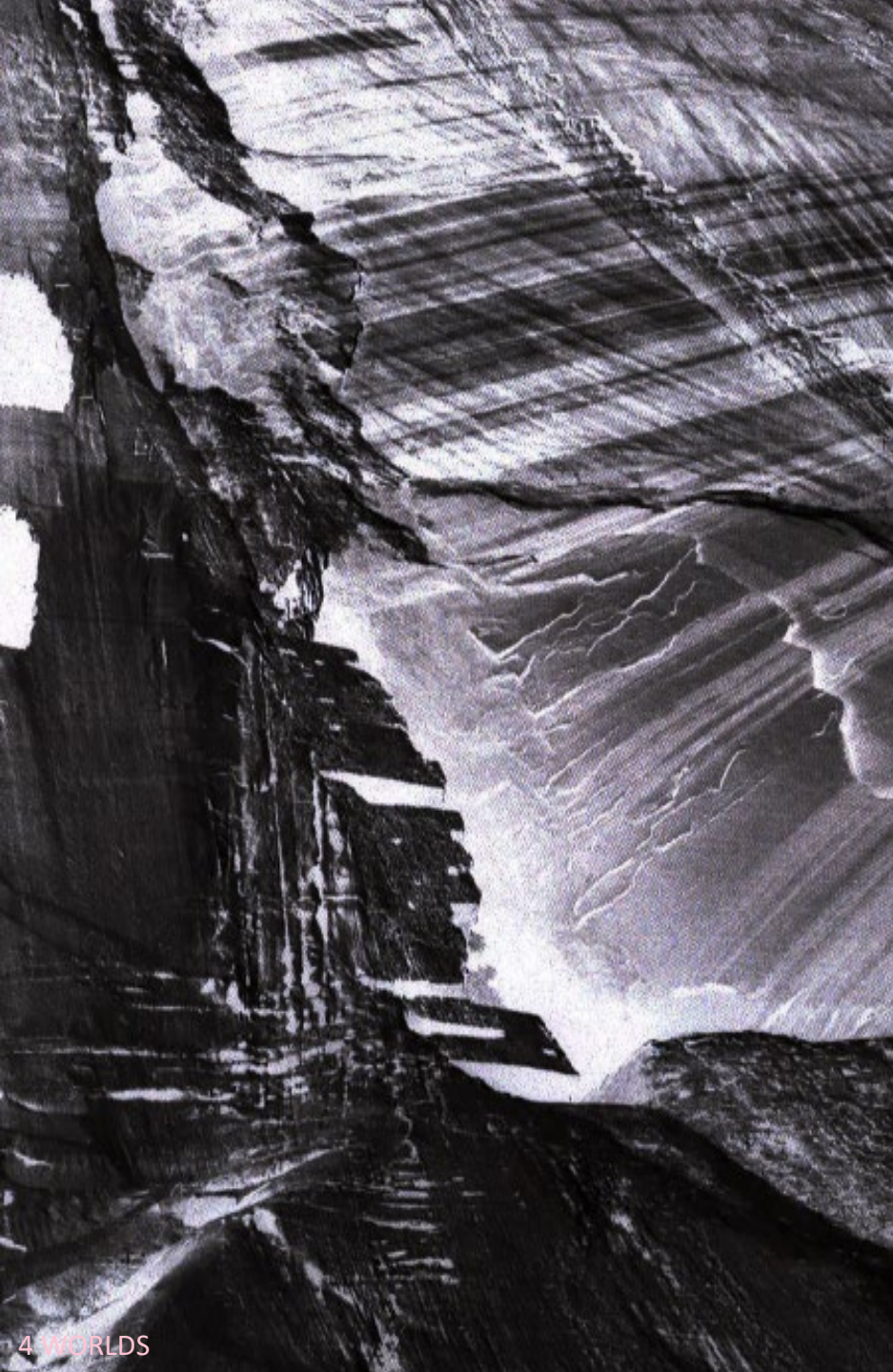

LANDSCAPE ARCHITECTURE
EDINBURGH

∨ ∧

EDINBURGH SCHOOL OF
ARCHITECTURE AND LANDSCAPE
ARCHITECTURE (ESALA)

∨ ∧

EDINBURGH COLLEGE OF ART
(ECA)

∨ ∧

THE UNIVERSITY OF EDINBURGH

ART SCHOOL

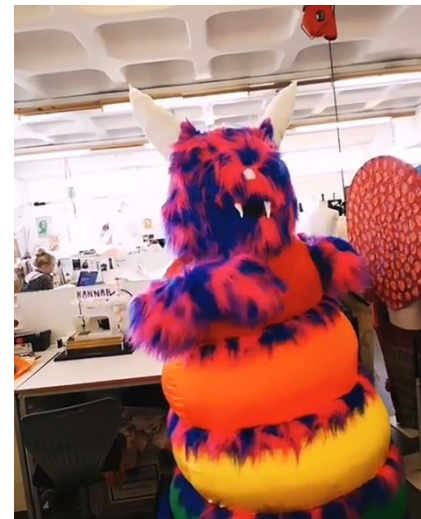



Wood workshop

This large wood workshop hosts a huge range of machinery and hand tools for the cutting, shaping, and general fabrication of woods, as well as metals, plastics, and cardboard.



Glass workshops

Edinburgh College of Art has well-equipped glass workshops for the blowing, cutting and casting of glass objects. The space includes hot and cold glass workshops and a plaster room.



Libraries

Students at the University of Edinburgh have access to a range of library resources across the campus and online.

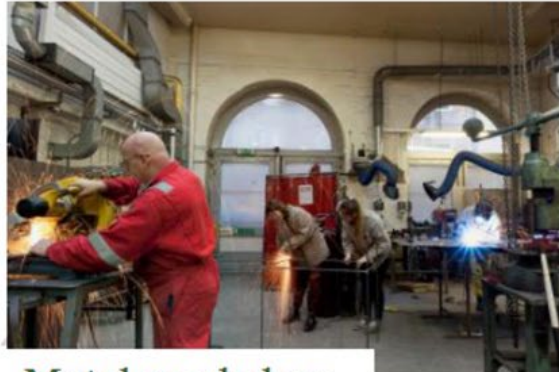

Metal workshop

Welding torches, a forge, forming and shaping tools, and a 1-ton gantry crane with access to main workshop areas.



Model workshops

We have model workshops in both the Hunter Building and Minto House. Here you can work with machinery and hand tools for the cutting, shaping, and general

UNDERGRADUATE

POST GRADUATE

CHARTERSHIP

EMiLA
At the University
of Edinburgh

Your background?

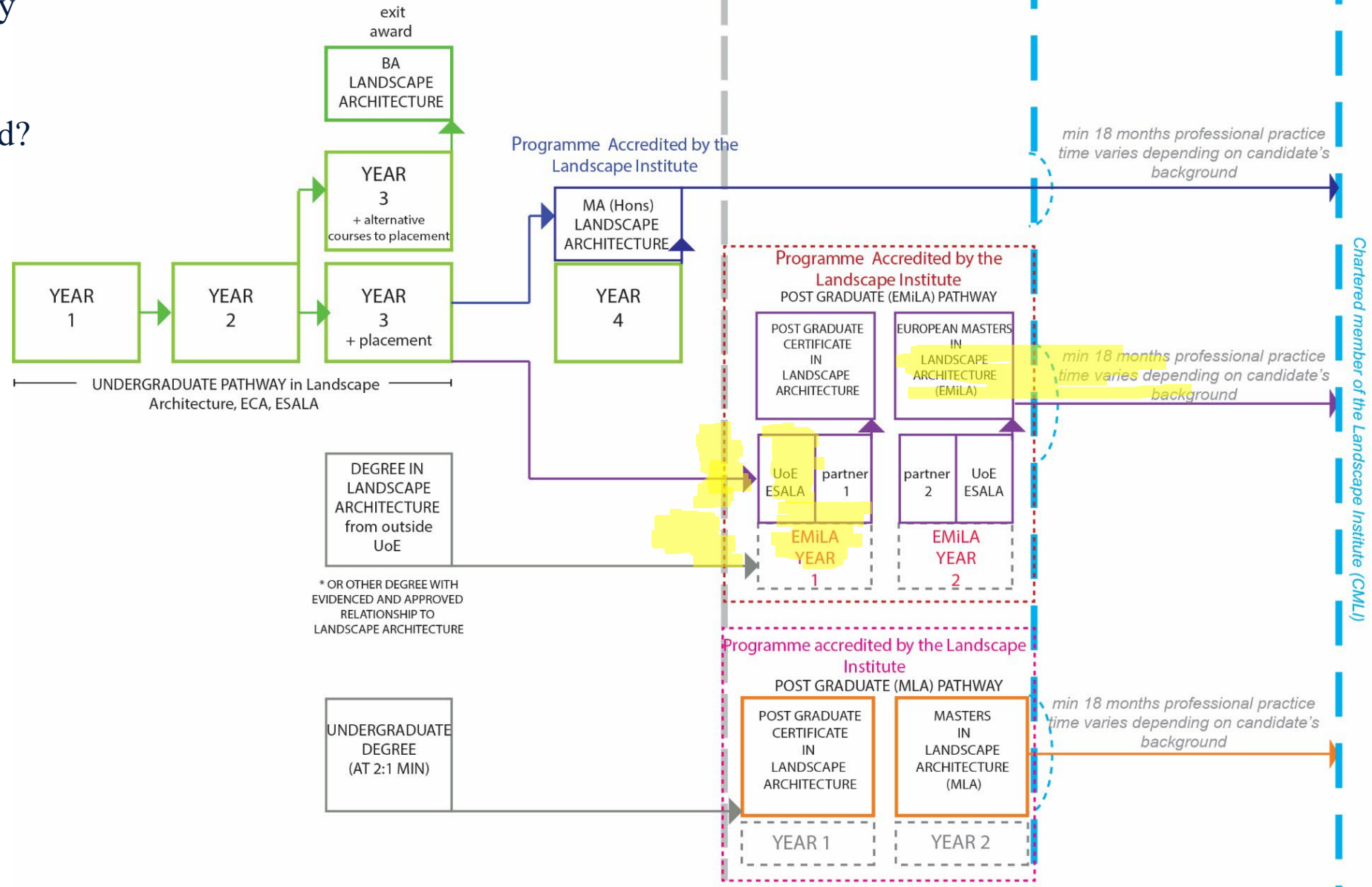

Diagram: Pathways to chartership in Landscape Architecture, ESALA, UoE

(PTMSC LDAEM1F)

[Jump to: Year 1, Year 2](#)

Year 1 Academic year: 2023/24, Starting in: September

NOTE A:

Students must take a total of 240 credits over 2 years, as laid out in this Degree Programme Table.

Please note:

If a student has prior knowledge from a previous degree or previous learning, the Semester 1 course above (Situating Landscape Architectural Theory ARCH11272) may be substituted for an elective course of 20 credits with the written permission of the Programme Director. That substitute elective course would be 1 x 20-credit option from Level 10 and 11 courses in Schedules A to Q, T, W and Y in semester 1 only.

Where indicated some courses must be passed at 50% with 1 resit attempt.

Compulsory courses

You must take these courses

EMiLA e-Learning module on
European Policies and Practices,
Academie van Bouwkunst
(Amsterdam)

ARCH11210 10 credits

Landscape architecture design
exploration: Part 1

Must be passed at 50% and taken during Semester 1

ARCH11271 40 credits

Situating landscape architectural theory

Must be passed at 50% and taken during Semester 1

ARCH11272 20 credits

Course options

Landscape Architecture (European Masters) (EMLA) - Year 1 placements - Level(s) 11-11

Select exactly 50 credits of the following courses

NOTE 8:

Students cannot undertake both placements at the same European institution. They must choose a separate institution for each placement.

SELECTED COURSES MUST BE TAKEN DURING SEMESTER 2

Placement 1 at Leibniz University
(Hannover)

ARCH11206 50 credits

Placement 1 at Escola Tècnica Superior d'Arquitectura de Barcelona (ESTAB), Barcelona

ARCH11208 60 credits

Placement 1 at Ecole Nationale
Superieure du Paysage
(ENSP), Versailles

ARCH11209 50 credits

Placement 1 at Academie van Bouwkunst (Amsterdam)

ARCH11212 50 credits

Strong prioritisation
of design courses
through the curriculum

DESIGN \diamond THEORY

UNIVERSITY OF EDINBURGH
YEAR 1 SEMESTER 1

DESIGN EXPLORATIONS
PART 1
40 CREDITS

SITUATING
LANDSCAPE
ARCHITECTURAL
THEORY
20 CREDITS

YEAR 1 SEMESTER 2

PLACEMENT AT PARTNER INSTITUTION
50 CREDITS

E - LEARNING
10 CREDITS

UNIVERSITY OF EDINBURGH
YEAR 2 SEMESTER 1

PLACEMENT AT PARTNER INSTITUTION
50 CREDITS

SUMMER
SCHOOL
10 CREDITS

YEAR 2 SEMESTER 2

DESIGN EXPLORATIONS
PART 2
40 CREDITS

ACADEMIC
PORTFOLIO
THEORY
20 CREDITS

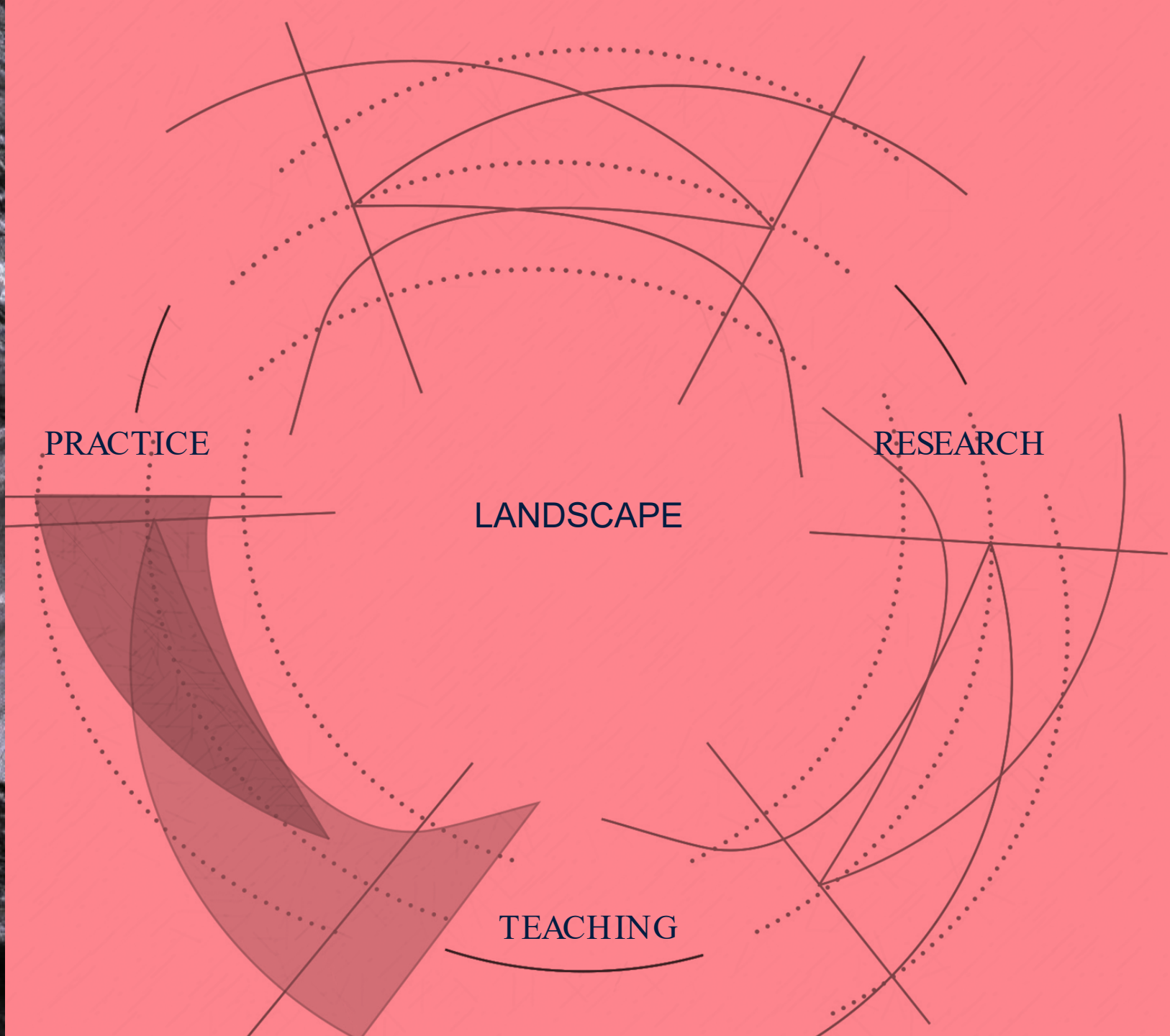
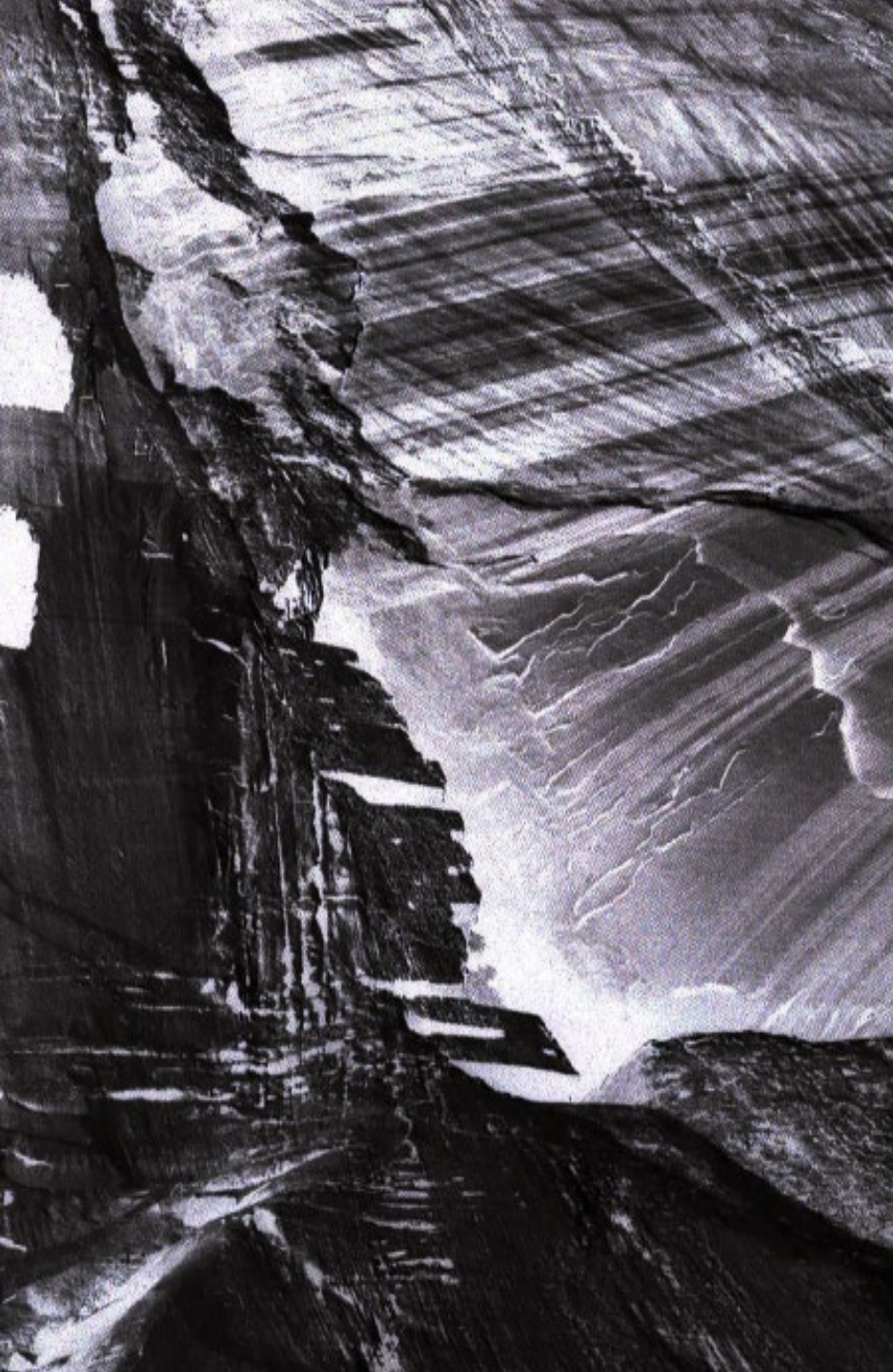

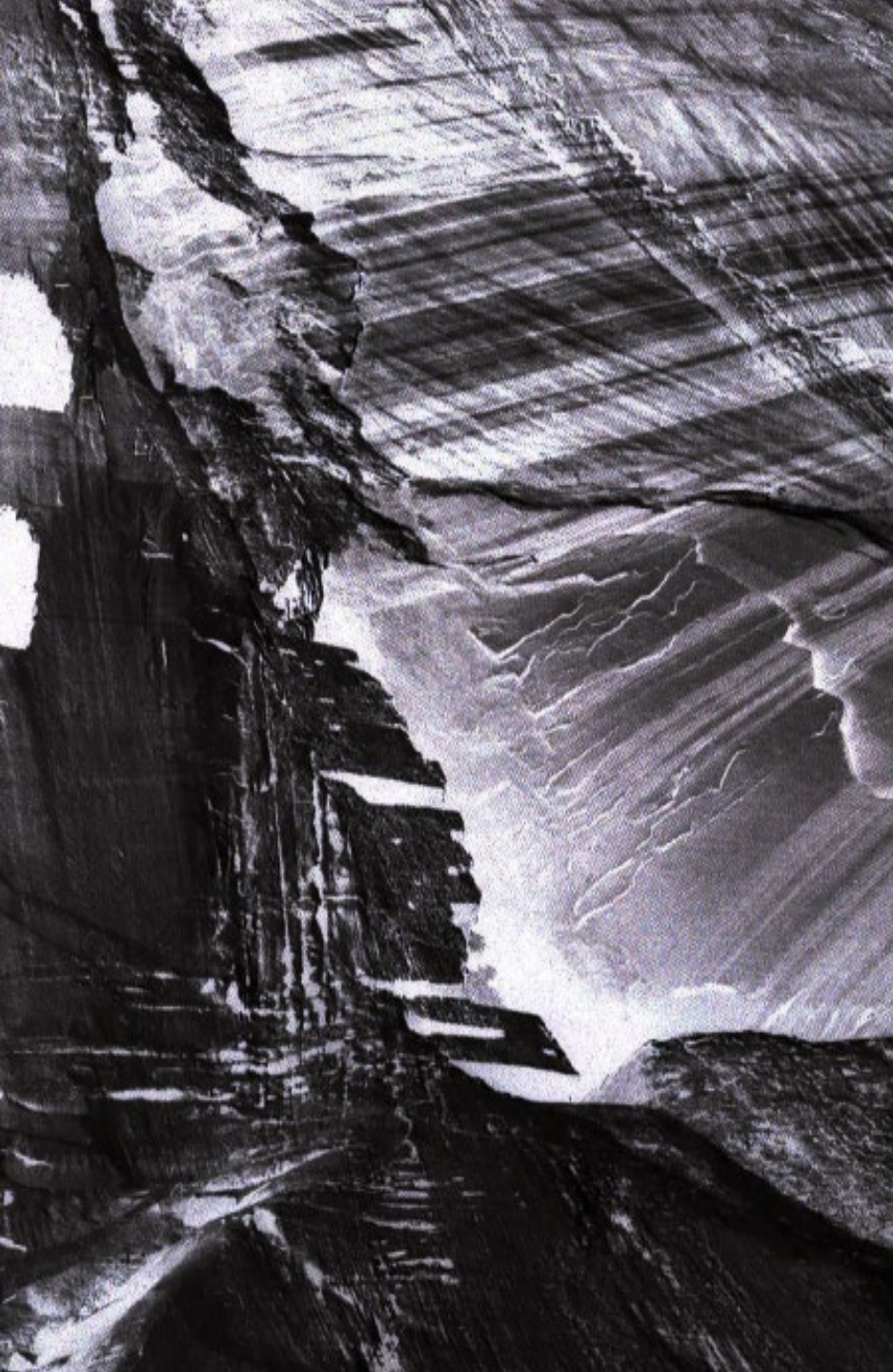

Design Courses
(Design Studio's) in Edinburgh are led by

FIELDWORK
SITE SPECIFICITY
SENSE OF PLACE

WORKING IN THE CONTEXT OF THE
CLIMATE AND BIODIVERSITY CRISIS

EXPERIMENTATION AND MAKING

CONSIDERING YOUR OWN POSITION
AND YOUR CAREER FUTURE

THE PROBLEM CONTEXT

Knowledge

DESIGN

THEORY

PRE -SITE VISIT

SITE VISIT

FIELDWORK

SITE ANALYSIS

PRE-CONCEPTUAL ANALYSIS

CONCEPT

DESIGN

TIMESCAPING

STEWARDSHIP

student driven
thematic

student driven
thematic

student driven
thematic

ENVIRONMENTAL

SUSTAINABILITY

SOCIAL

INCLUSIVITY

EQUALITY

ETHOS AND PROBLEM FINDING

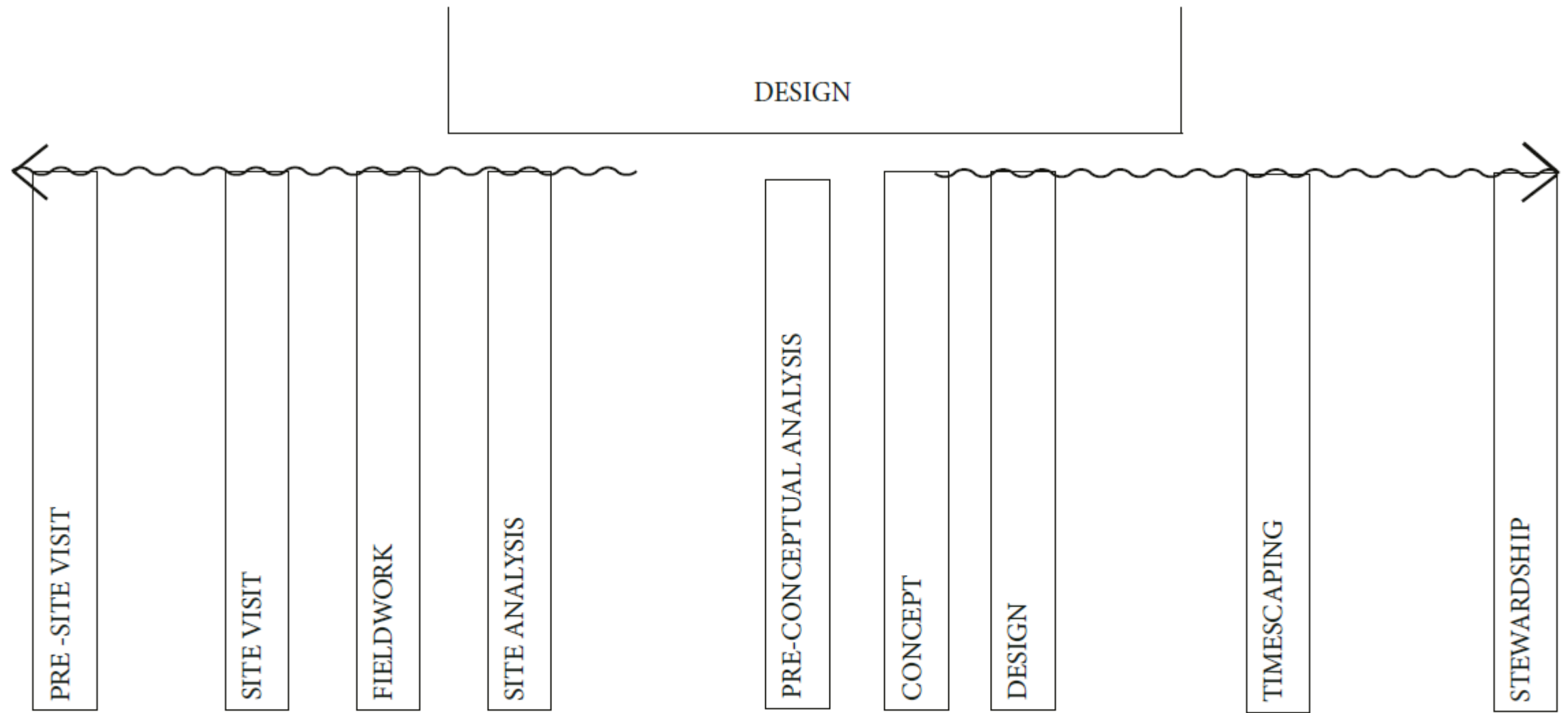

EXPAND THE DESIGN PROCESS PARTICULARLY IN STAGES OF INCEPTION AND POST-PROJECT TERRITORIES

WHY?

MULTI-DIRECTIONAL KNOWLEDGE EXCHANGE, PLUARALITIES OF UNDERSTANDING, EXCHANGE AND FEEDBACK,
SEPARATE KNOWLEDGE FIELDS COLLAPSE INTO EACH OTHER - PLANETARIZATION RATHER THAN GLOBALIZATION - UNDERSTANDING

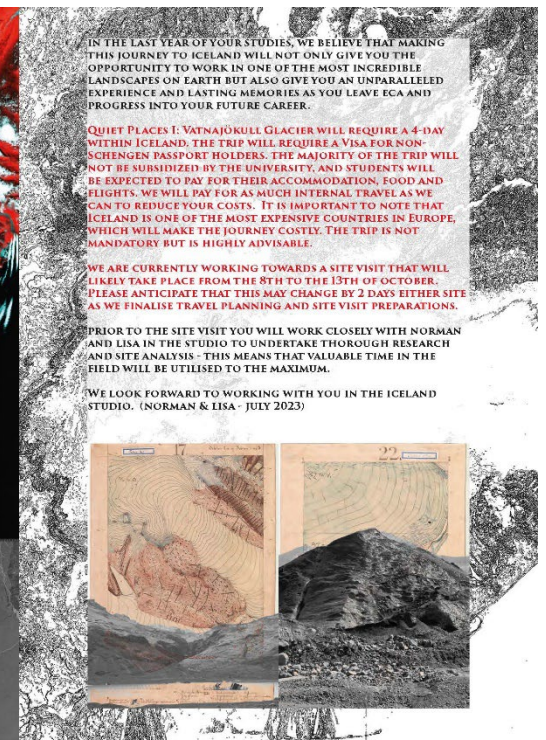
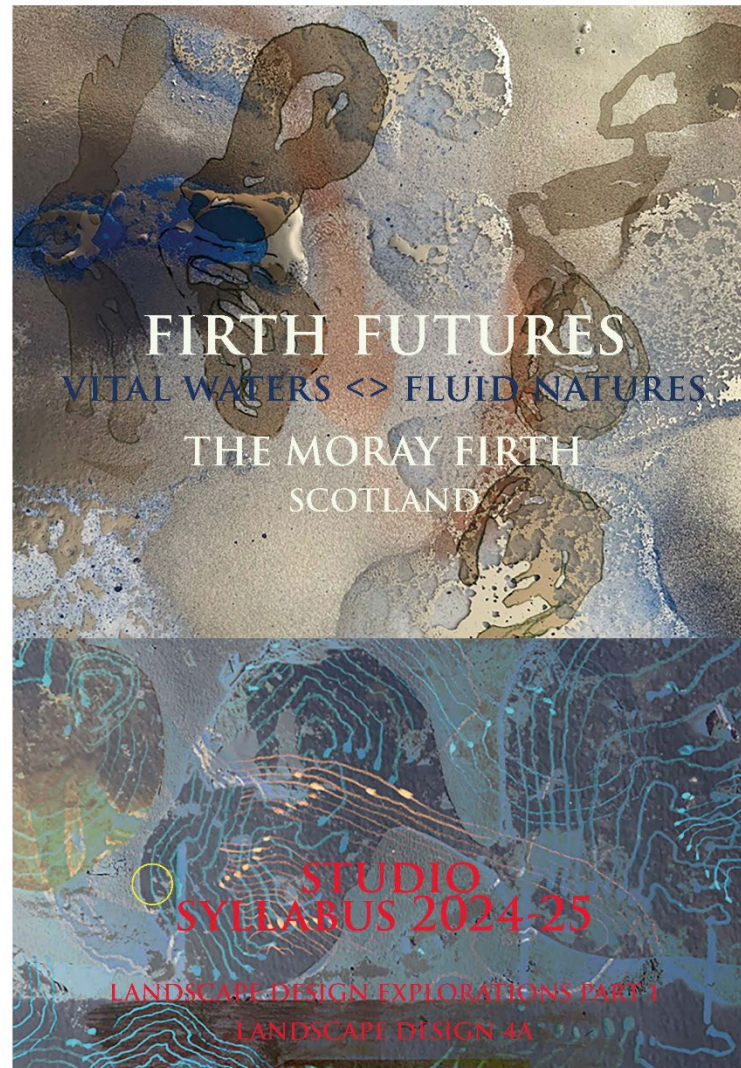

FIRTH FUTURES– MORAY FIRTH – SCOTLAND
 VIBRANT MATTER – DUNBAR, ST ABBS – SCOTLAND
 ICELAND – VATNAJOKULL NATIONOAL PARK

CRITICAL ZONES | THE
HIGHLAND BOUNDARY FAULT

THE CRITICAL ZONES STUDIO (2023-24) INVITES SECOND-YEAR MLA AND FOURTH-YEAR MA STUDENTS TO JOIN ANNA RHODES AND ANNA REID ON A COLLECTIVE EXPLORATION OF SCOTLAND'S HIGHLAND BOUNDARY FAULT ZONE.

This studio's journey begins 450-400 million years ago with the formation of a line, a geological fault now barely visible, which today separates two distinct regions: the Scottish Highlands and the Lowlands. Journeying through time, we will collectively investigate the geodiversity of the Highland Boundary Fault zone. Written in the rocks, landforms and soils, are stories of ancient collisions and eruptions, changing climates, how ecologies have evolved and how water and ice have continuously sculpted landscapes to the present day.

Constantly shifting our investigations from transects spanning dramatic topographies, timescapes and an array of landscape typologies to detailed studies at microscopic scales, immersive and experimental fieldwork will allow us to explore and articulate vast perspectives and worlds typically unseen. These interdimensional readings will include a focused field study to points of thematic interest within the Highland Boundary Fault Zone, where we will actively explore geomorphology, surfaces, ecology and society.

From investigations spanning scales and deep time, landscapes that are facing social and environmental pressures located within the Highland Boundary Fault zone will inform bold design speculations on how future landscapes can mitigate the problems we are currently facing and are yet to face within the geological era of the Anthropocene and in this time of Climate Emergency.

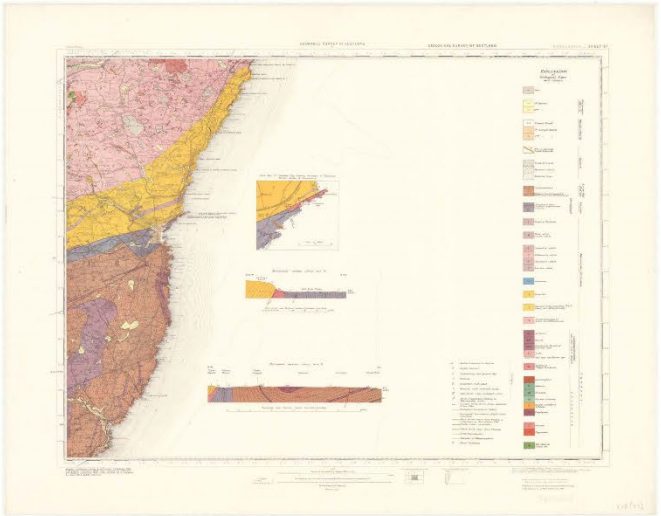
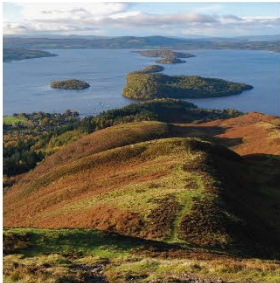
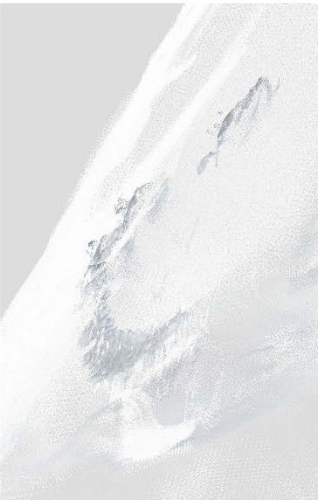

THE CRITICAL ZONES STUDIO WILL INCLUDE A FOUR-DAY TRIP TO POINTS OF INTEREST WITHIN THE HIGHLAND BOUNDARY FAULT ZONE WITHIN WEEK 4 (9-13TH OCT). The majority of the trip will not be subsidised by the University and students will be expected to pay for their accommodation and food. To help reduce your costs we will pay for as much of the travel as we can. The trip is not mandatory but is highly advisable. Later in the academic year, once you have established your own field of enquiry, working within this local context means repeat independent fieldwork is possible.

Anna Rhodes and Anna Reid will be your primary tutors with occasional assistance from allied specialists and guest critics. We will tailor our teaching and respond to your individual study interests. The last year of your studies is your own and we look forward to supporting your unique exploration.



Left to right:
Ed O'Donnell. Archive image: Arran Agriculture.
Walkhighlands. View from Conic Hill of Highland Boundary Fault
National Museums Scotland. Old red sandstone conglomerate from Perthshire
Geological Survey of Scotland, Stonehaven Sheet 67 (1929) Ordnance Survey Office, Southampton.

All other images collected from within the HBF zone by A.Rhodes (2022-23)

Fieldwork
ICELAND
October 2023



Fieldwork
ICELAND
October 2023



RETURNING
TO THE STUDIO
AFTER BEING
IN THE FIELD

HOW DO I 'PLOT A
COURSE' IN MY
DESIGN WORK?



WHAT KIND OF IDEAS AND WAYS OF THINKING
ARE BROUGHT OUT IN THE STUDIO TEACHING?

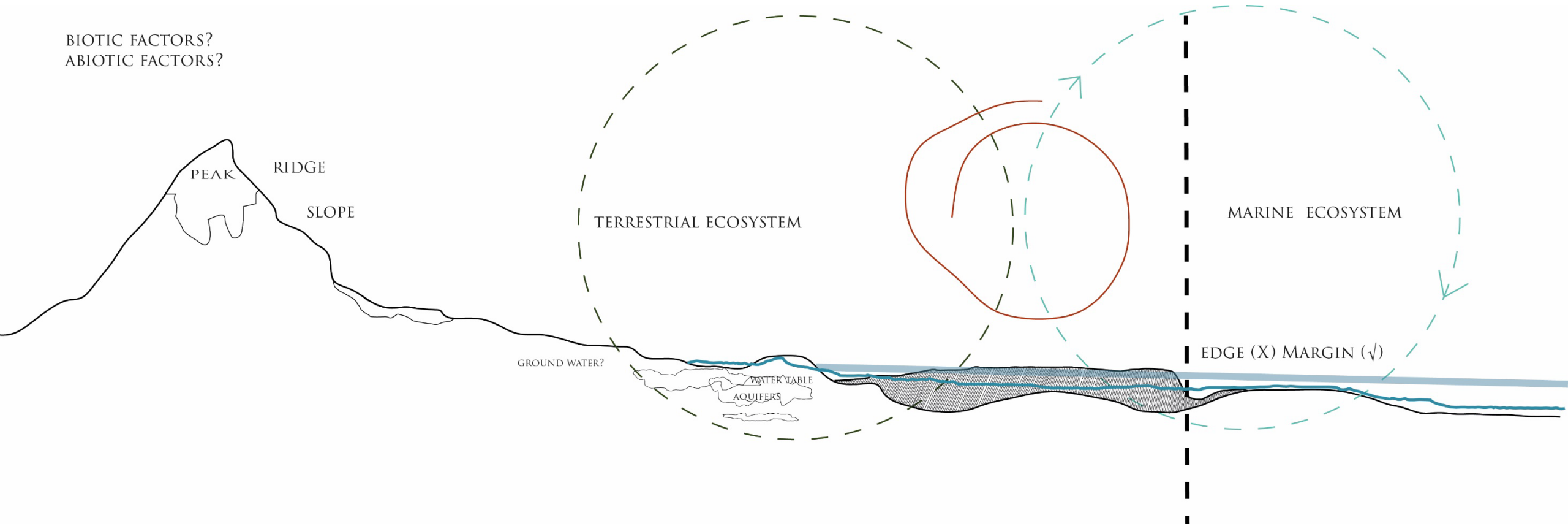

How do we think of, work with and make long term plans for the future of our planetary resources?

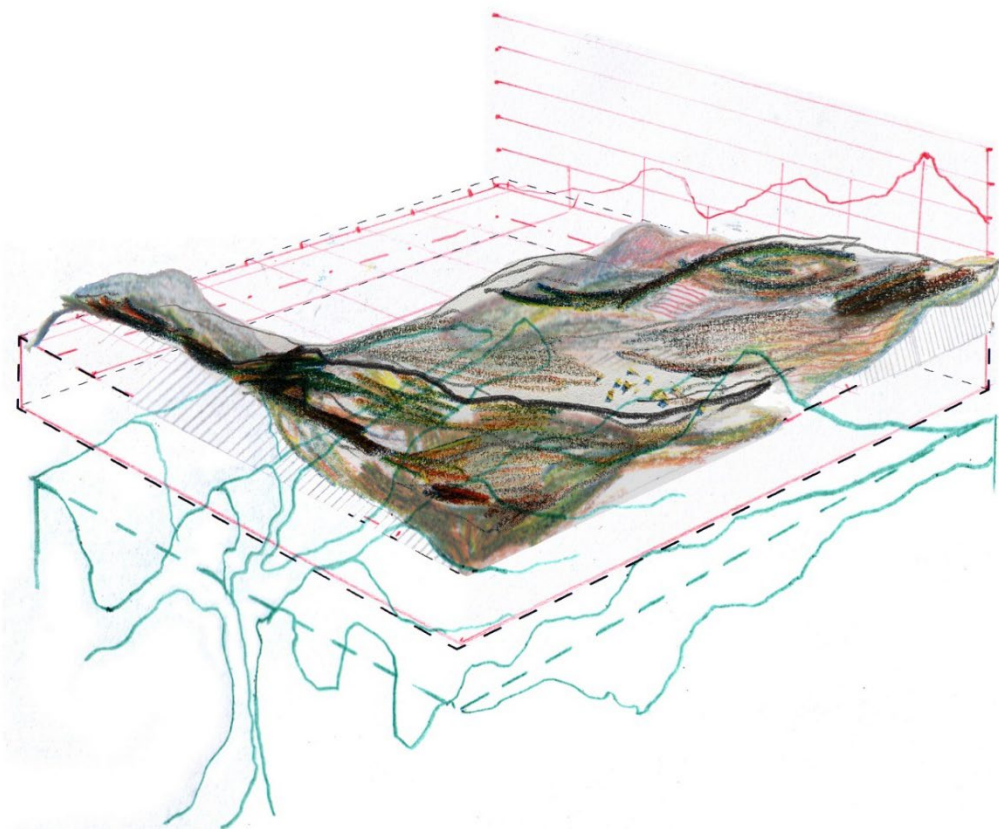
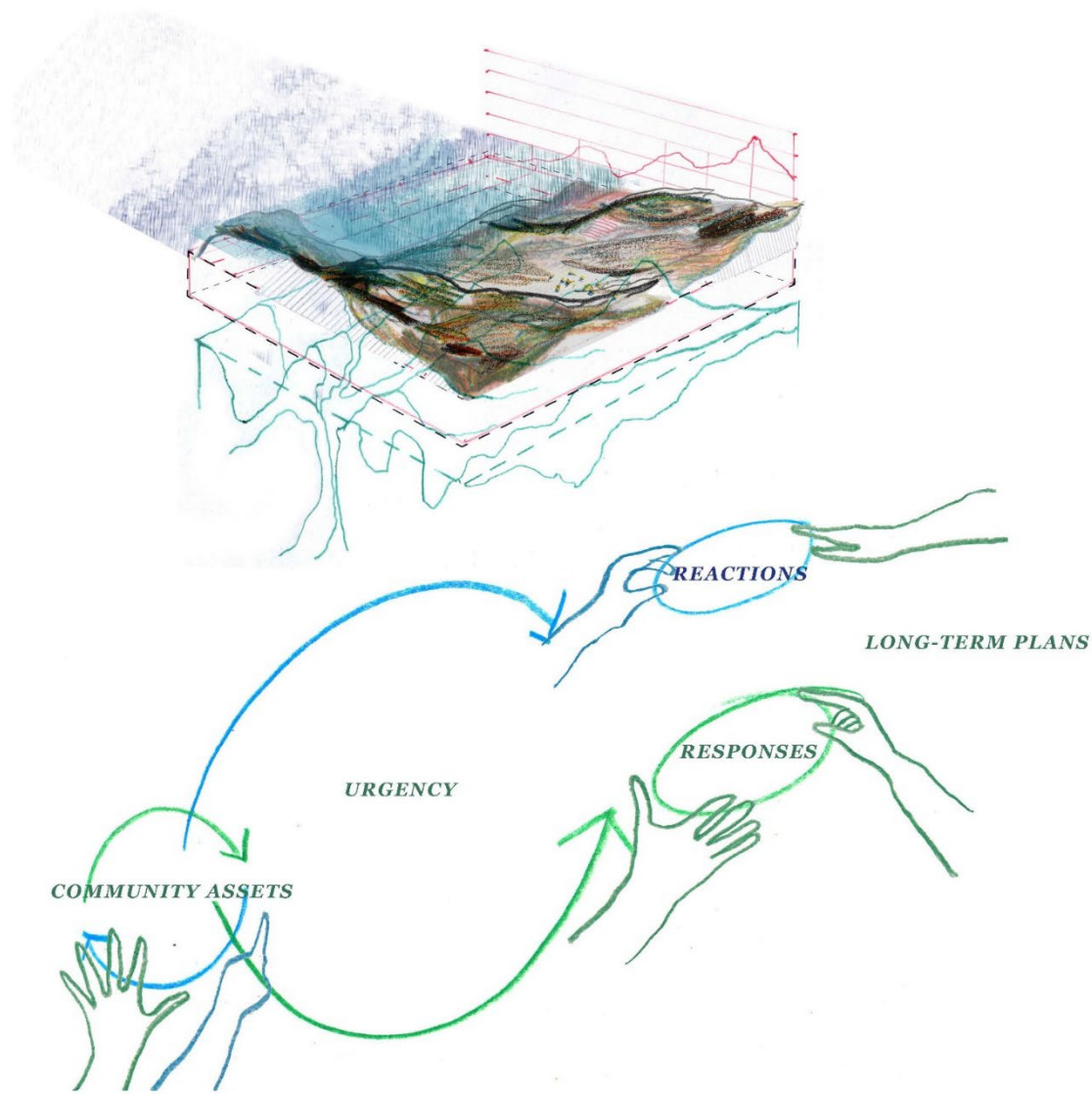

Studio work





Studio work

Left – Freddy Wacker, Hannover, December 2023
Above – Babs Brand, Amsterdam, December 2023



Emily Student, Beatriz Saladián from Barcelona, December 2022



EMiLA student, Tim Gamperle – From Amsterdam, 2022



DEGREE SHOW- FOR GRADUATING YEARS IN LANDSCAPE
ARCHITECTURE - ECASculpture COURT JUNE 2024

Strong prioritisation
of design courses
through the curriculum

DESIGN \diamond THEORY

UNIVERSITY OF EDINBURGH
YEAR 1 SEMESTER 1

DESIGN EXPLORATIONS
PART 1
40 CREDITS

SITUATING
LANDSCAPE
ARCHITECTURAL
THEORY
20 CREDITS

YEAR 1 SEMESTER 2

PLACEMENT AT PARTNER INSTITUTION
50 CREDITS

E - LEARNING
10 CREDITS

UNIVERSITY OF EDINBURGH
YEAR 2 SEMESTER 1

PLACEMENT AT PARTNER INSTITUTION
50 CREDITS

SUMMER
SCHOOL
10 CREDITS

YEAR 2 SEMESTER 2

DESIGN EXPLORATIONS
PART 2
40 CREDITS

ACADEMIC
PORTFOLIO
THEORY
20 CREDITS



Fieldwork– Seawork - by Boat
The Netherlands, 2023 and 2018



Nikos Kourampas, Sedimentary Geologist, Summer School Fieldwork, Scottish Highlands, Sept 2022



The EMiLA Summerschool_Scottish Highlands, 2023
October 2022

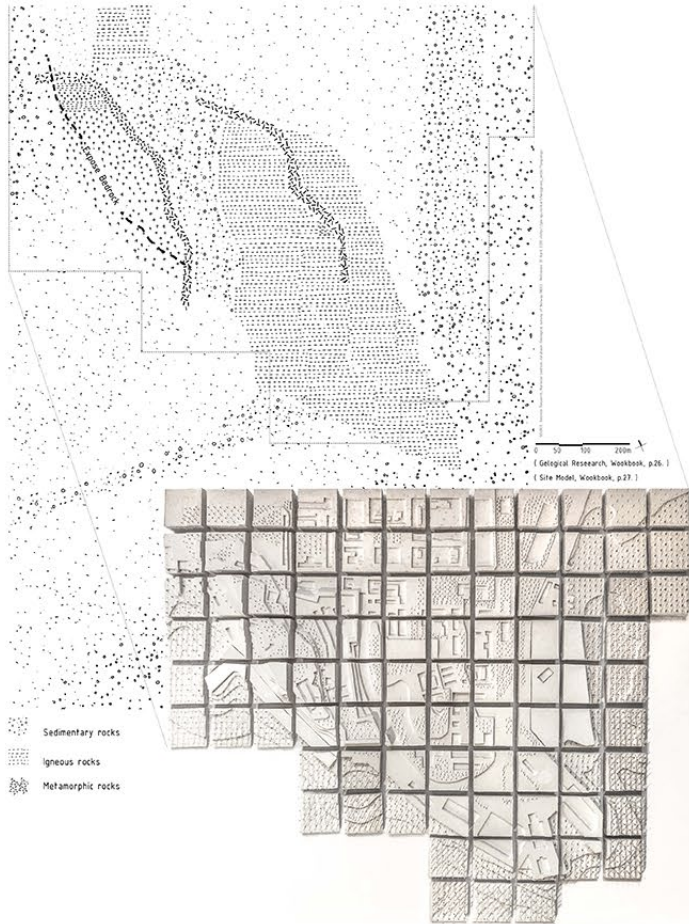

Neglected bedrock

The Akersnes peninsula has a unique geographical feature characterized by glacier movement. Therefore, there are many kinds of rocks, which overlap each other. However, most of the bedrock is covered by artificial elements like buildings, walls, and concrete paving. At present, only the western side of the peninsula has retained continuously cliffs. And such exposed bedrock is extremely rare in Oslo city center.

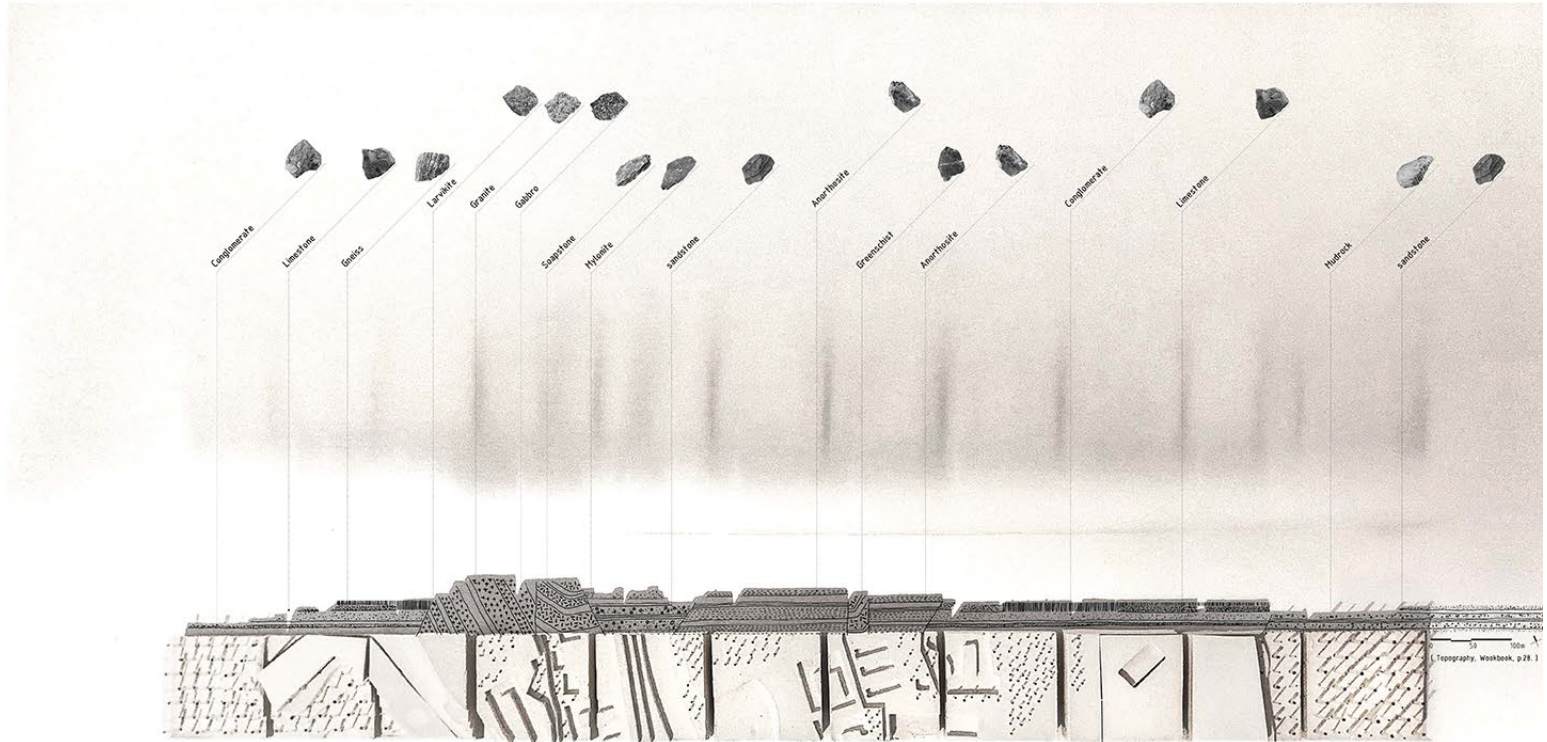

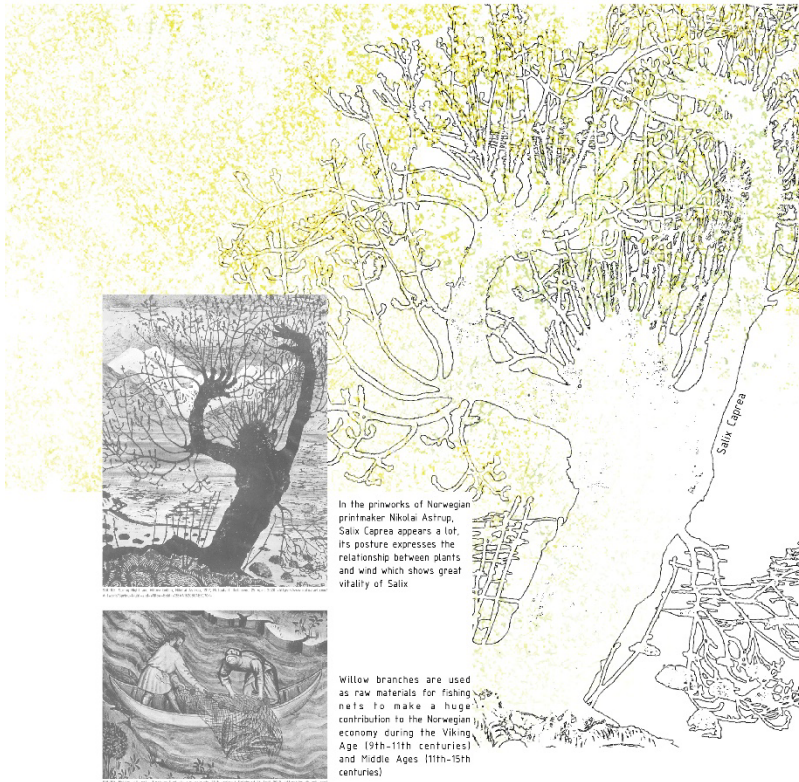

In the primeworks of Norwegian printmaker Nikolai Astrup, Salix Caprea appears a lot. Its posture expresses the relationship between plants and wind which shows great vitality of Salix

Willow branches are used as raw materials for fishing nets to make a huge contribution to the Norwegian economy during the Viking Age (9th-11th centuries) and Middle Ages (11th-15th centuries)



Making willow flutes (Norwegian: seljefløyte) from goat willow (Salix Caprea) branches is common in Norwegian history.

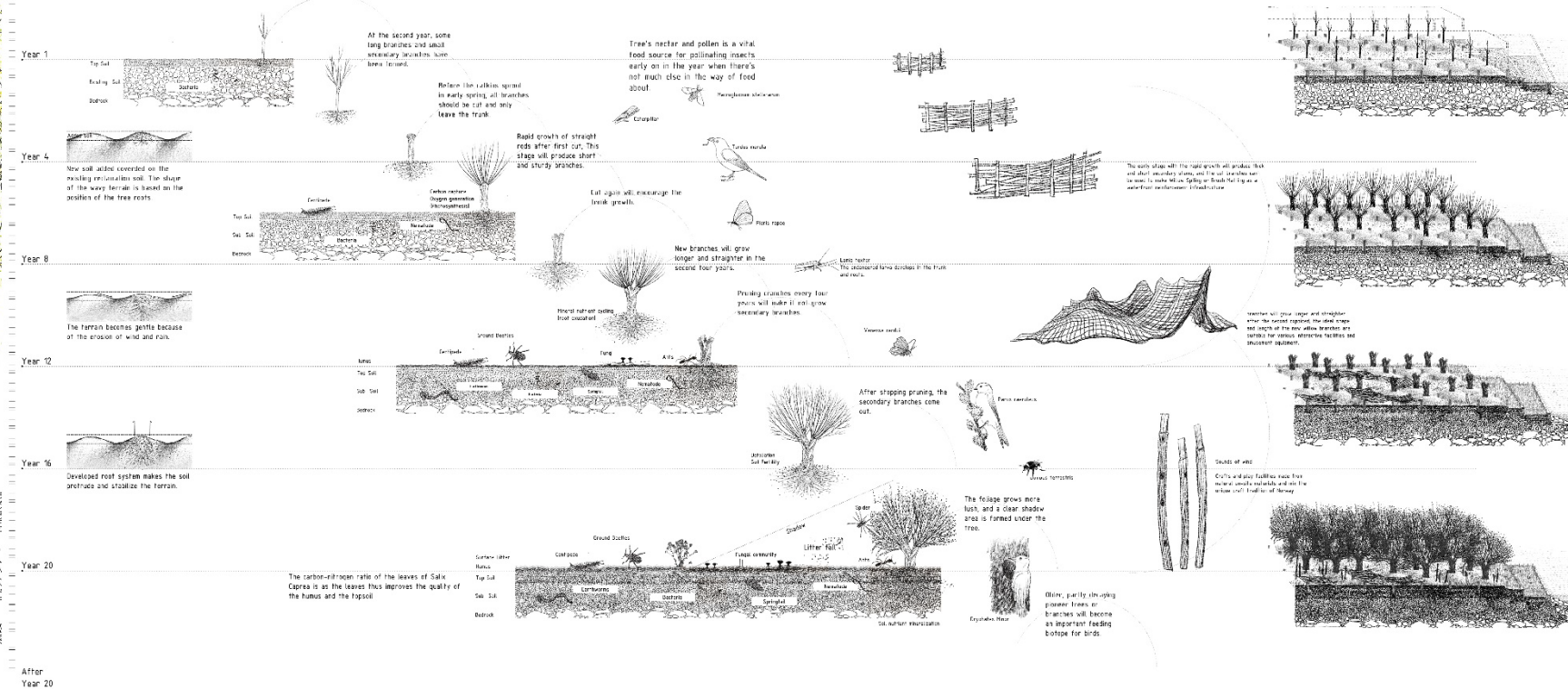

Salix Caprea – A rouser of Spring

Salix was among the earliest recorded pre-Ice Age flowering plants. Usually, use as pioneer tree species that can grow in storm-damaged areas.

Salix as an ecological factor has great value for wildlife as Pollen source, nectar provider, and forage plant. And also as a positive means to improve the soil quality of the original reclamation soil. The growth process of a coppiced tree also bring a lot of products that help to enhance people and nature's connection.

The island of the Winds – A landmark as a weathervanes

Intervene in the environment affected by the wind by planting trees to create a more comfortable ground environment, and let the wind become the engine to encourage the exchange of interaction between substances, because the role of wind drives the flow of pollen and seeds, water and mist.

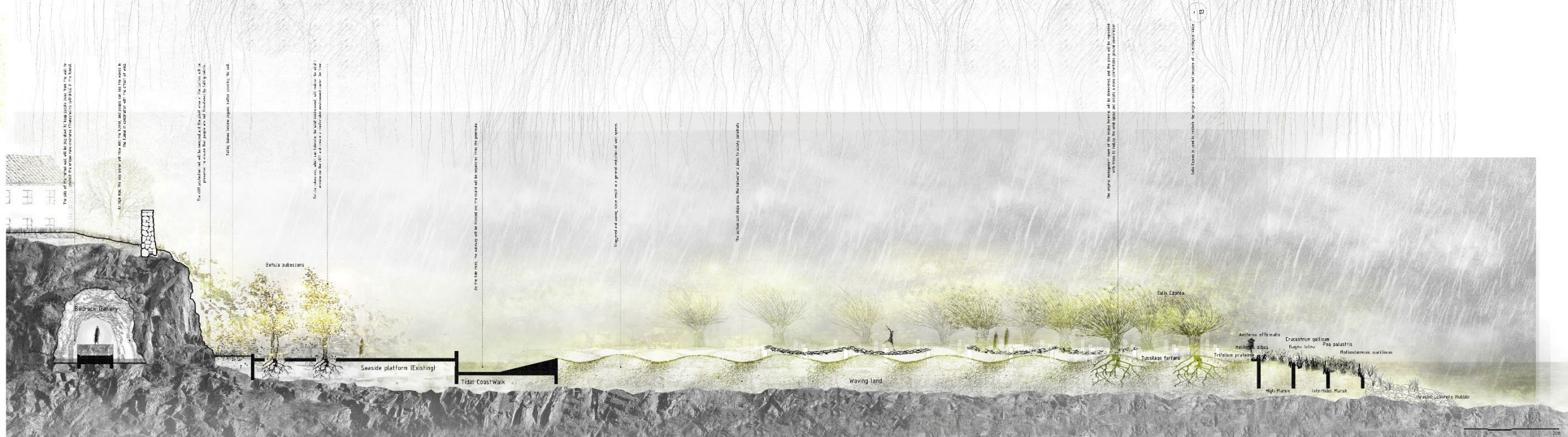

lot of products that help to enhance people and nature's connection.

ESALA DECLARES



THE UNIVERSITY of EDINBURGH
Edinburgh College of Art



Event: Smart Places Panel Discussion

Join us for the Smart Places Panel discussion: a live online discussion and public Q&A with the 7 Smart Places...



Uppland

Please join us for screening of Uppland: 25th March 2020, 6-7pm Adam House Theatre

Uppland (26 mins) is a film made by architect Kieran Doherty and director Edward Linnemann that traces the complex relationship between landscape, displacement and the global extractive industries, within and beyond Sub-Saharan Africa. Uppland has screened internationally at Open City Days, the 2018 Venice Biennale and 2019 Seoul Biennale of Architecture and Urbanism (2019) and can be viewed online on the Creative Commons BY-NC-SA license.

This screening will be preceded by a short introduction by Richard Anderson and followed by a discussion (30 mins) between Kieran Doherty (ESALA), Professor Ole Urbahn (Manchester School of Architecture) and Dr Sara Spengen (Centre for African Studies) around extraction, urbanisation and the environmental social implications that extraction presents.

This ESALA Declare and Centre for African Studies joint event follows the book launch of *Stone To Ground: A History of Environment & Infrastructure in Dar es Salaam* by Dr Emily Brunsell - 6-8.30pm in the Violet Lecture room, Crystal Macmillan building.

Centre for African Studies



RACHEL ARMSTRONG

10 March 2020
17:30-19:00

Lecture Theatre B
David Hume Tower

ON LIQUID LIFE:
TOWARDS MICROBIAL ARCHITECTURES

The background is an abstract composition of various shades of blue and green, with a grainy, textured appearance. A prominent, dark, winding line, resembling a river or a path, starts from the left side and curves towards the bottom right. There are also some lighter, yellowish-green patches scattered throughout the blue areas.

THE MEDIATORY POWER OF LANDSCAPE,
LANDSCAPE ARCHITECTURES CAPACITY AS A DISCIPLINE
TO FACILITATE IDEAS BETWEEN PEOPLE TOWARDS
CONSENSUS AND ACTION

Asking questions (Microsoft Teams)

- Type your question into the Chat Area

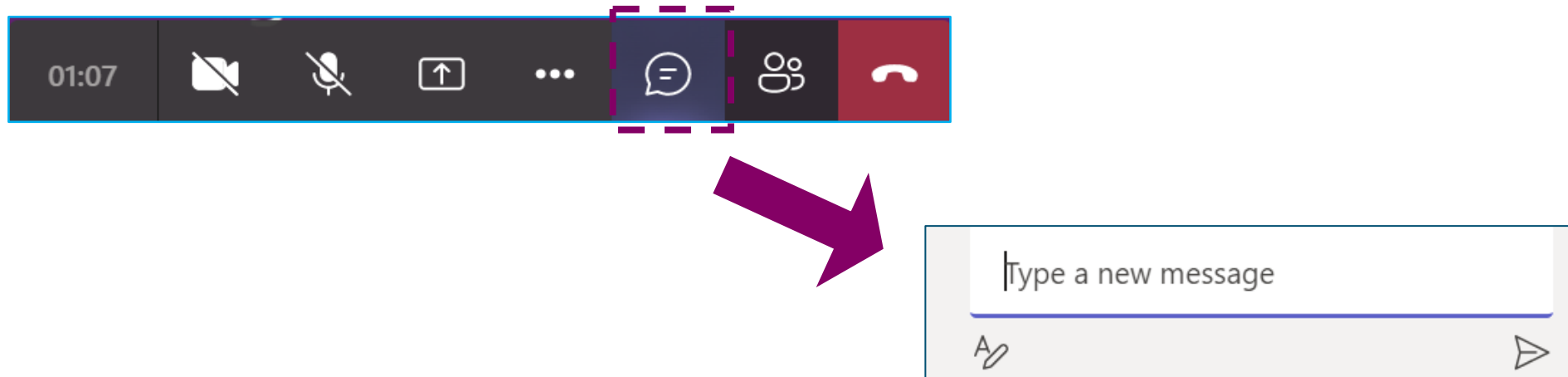

Next steps...

<https://virtualvisits.ed.ac.uk/pg>



<https://edin.ac/student-chat-pg>



THE UNIVERSITY
of EDINBURGH

EDINBURGH
extraordinary futures await

Contact details for follow-up questions

- We apologise if we did not get through all of your questions in the time allotted for this session. If you have further questions that have not been answered, please email: futurestudents@ed.ac.uk



Thank you – click ‘Leave’ when the session ends

- Return to your ‘e-ticket’ to find and attend other sessions you’ve booked – by clicking on the button in the email we sent you...

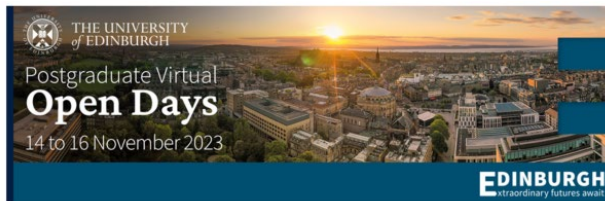

It's Day One!

Hi {{contact.full_name.first_name|case:camel}},

It is Day One of our Postgraduate Virtual Open Days! We are looking forward to welcoming you during the day.

Joining the event

To access the event, use your 'ticket' link below. The sessions are listed in chronological order and the times shown are in Greenwich Mean Time (GMT). The link to join a session will appear 15 minutes before it starts.

[Virtual Open Days Ticket](#)

- ...and visit the event homepage:
- <https://edin.ac/3CymWA3>



THE UNIVERSITY
of EDINBURGH

EDINBURGH
extraordinary futures await



THE UNIVERSITY
of EDINBURGH

Thank you

Lisa Mackenzie

l.mackenzie@ed.ac.uk